

INSTALLATION INSTRUCTIONS*

Requirements

- Compressor pressure should be set between 90–100 psi
- Must be used with an equal or greater amount of soffit vent
- Installs on pitches from 3/12 to 16/12
- Use with standard 12" wide cap shingles
- Use 1 3/4" nails provided to assure penetration into the sheathing 3/4" or completely through the sheathing

STEP 1

Cut a slot in plywood along the roof ridge 1 1/2" wide (3/4" on each side). If ridge beam is present, cut slot 3/4" wide on each side of ridge beam. Allow for a closed area of sheathing 12" at both ends of ridge.

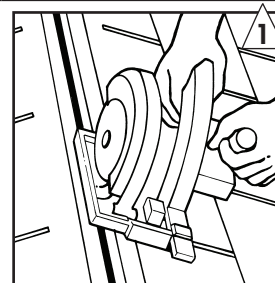

STEP 2

Place beginning female end of vent 1" in from gable end and use centering line for proper alignment along peak. Fasten using at least two nails at each end and in middle of roll in nail line area (1 3/4" minimum nail length) spacing approximately every 12 inches. More nails may be required on steeper slopes to seat properly. Continue installing additional rolls as needed along ridge sliding female end over male end, aligning using centering line. When reaching the other end, cut vent roll to 1" from the gable end and nail in place. End plugs are provided every 6" on the underside of the product.

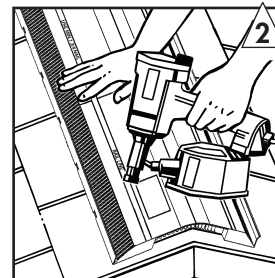

STEP 3

Place first cap shingle over vent so that it overhangs at least 1" over end of vent roll. Install with 1 3/4" nails provided in nail line area as you work your way down the roof. Cut last cap shingle so that it overhangs vent 1" at other gable end.

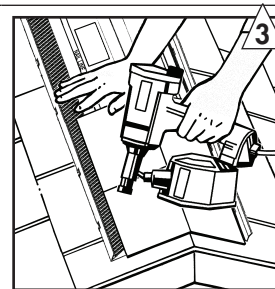

* Please consult Xtractor Vent Application & Architectural Drawings brochure for proper installation with hip & ridge applications.

SPECIFICATIONS

Length	25'
Height	5/8"
Width	14"
NFA	12.75 sq. in./ft.
Quantity	1 roll per box
Warranty	40-year limited

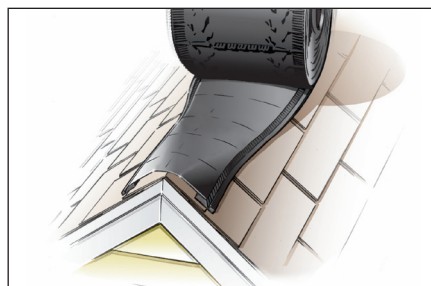

No more sections to piece together—the rolled design of XLP Turbo allows for quick and easy installation.